

## Pendulum jigsaws



### Power and precision

Most jigsaws have a hard time staying on course. Tough workpieces and curves can easily cause the blade to sway out. The result? Time-consuming finishing work like sanding or even recutting.

The Festool Trion solves the problem. Parallel-adjustable carbide-tipped jaws provide three-way blade guidance to ensure precise perpendicularity to the table at all times, even in curves. A splinter guard protects against chipping.

The result? A clean, precise cut to the scribe mark through the entire depth of the workpiece, with little or no finishing.

The Festool Trion jigsaws are among the most powerful jigsaws in existence, with a full 720 W. They can cut 4 3/4" wooden beams, 3/4" aluminum, or 3/8" steel. All our jigsaws feature adjustable pendulum stroke for powerful forward travel.

All this power and precision is exceptionally easy to control. Our jigsaws are particularly well-balanced to allow the power of the hand to be used to its best advantage. This is a significant benefit for one-handed use and work on vertical

### The benefits at a glance

#### Better results in a shorter time

- Patented three-way blade guide for precise perpendicular cuts.
- Splinter guard for splinter-free cuts.
- Multi-Material-Control electronics for constant cutting speed and cleaner cuts.
- 0-45° bevel adjustment for bevel and miter cuts.
- Non-scarring base plate.

#### Easier work

- Easy "FastFix" blade change.
- Low center of gravity and ergonomic switch placement for untiring work.
- Efficient chip and dust extraction for reduced cleanup and better working environment.

#### Reduced total costs

- Highly durable, sturdy long-life components.
- Backed by our 3-year warranty.

and overhead surfaces. The Trion comes in two configurations to suit the way you work.

### Smooth running

Electronic Multi-Material Speed Control gives you the correct constant speed for the material you're sawing. It prevents overheating, and keeps the saw running smoothly.

### Versatility

You can set a bevel to 45° on either side, and you can even start cuts in wood without a pilot hole. You can set the blade to a straight or pendulum motion, depending on the material. You even get a choice of handle styles to fit the way you work – the barrel-grip PS 300 EQ, or the PSB 300 EQ with D-handle for easier one-hand use.

### Dust and Chip Extraction

Suction ports on both sides of the blade ensure efficient extraction. The Trion integrates with our quiet CT dust extractors for clean working with the convenience of tool-triggered autostart.

With Festool CP saw blade guide    Without saw blade guide

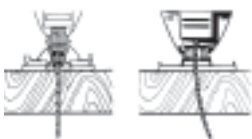

#### Perfect guidance for precise cuts

The Trion has 3-way blade guidance – first by the pendulum rod, second by the pendulum guide roller, and third at the cutting point by two carbide plates, the patented CP (Carbide Precision) blade guide. The blade stays at exactly the pre-set angle, for precise cuts of all kinds including bevel or miter cuts, and reduced sway out in tight radius cuts. You get virtually no cutting errors, spoiled workpieces, or need for reworking.

#### No more splintering

The simple but effective splinter guard ensures perfect, splinter-free edges. The splinter guard is automatically cut to shape by the saw blade immediately after fitting. This gives you clean cut edges and avoids the need for laborious reworking.



*Suction ports are located on both sides of the blade.*

*The Trion powers through thick workpieces.*

# Pendulum jigsaws

## Barrel grip jigsaw



### Trion PS 300 EQ

- High power
- 3-way blade guidance
- Splinter guard for splinter-free cuts
- Adjustable pendulum stroke for powerful forward movement
- Electronic speed control
- Non-scarring stable base plate
- Dust extraction

## D-handle jigsaw



### Trion PSB 300 EQ

The **Trion PSB 300 EQ** has all of the benefits of the Trion PS 300 EQ, as well as:

- Special D-handle for easy one-handed use

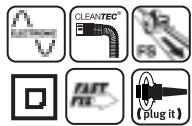

### PS 300 EQ/PSB 300 EQ

Includes:

- 2 multipurpose wood saw blades
- 1 splinter guard • Chip deflector
- Plug it power cord • In Systainer 1

PS 300 Item No. 561 097.....Price \$280.00

PSB 300 Item No. 561 123.....Price \$280.00

See page 5 for package savings.

### Trion PS 300 EQ/Trion PSB 300 EQ

Power Consumption	720 watts/6 amp 120 v AC
Stroke rate (1")	1,000 - 2,900 spm
Pendulum stroke adjustment	4 stages
Bevel adjustment	0° - 45°
Cutting depth, wood	4 3/4" (120 mm)
Cutting depth, non-ferrous metals	3/4" (20 mm)
Cutting depth, steel soft	3/8" (10 mm)
Weight	5.06 lbs. (2.3 kg)/5.29 lbs. (2.4 kg)

(Metric dimensions binding)

## Accessories for pendulum jigsaw PS 300 EQ/PSB 300 EQ/PS 2 E

### Guides and stops

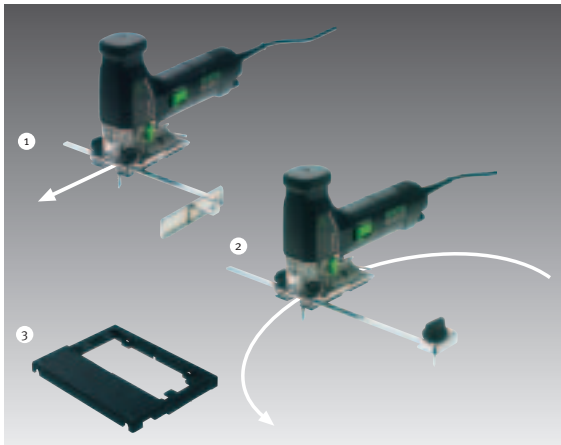

No.	Description and application	Type	Item No.	Price
1	<b>Parallel stop</b> for use with material up to 7 7/8" (200 mm) wide	PA-PS	490 119	22.00
2	<b>Circle cutter</b> for cutting circles with diameters of 4 23/32" - 28 11/32" (120 - 720 mm)	KS-PS	490 118	21.00
3	<b>Guide stop</b> gives absolutely straight cuts with the FS guide system For PS 300/PSB 300 jigsaws For PS 2 jigsaw	FS-PS/PSB FS-FS/PS 2	490 031 486 721	10.50 10.50

### Other accessories

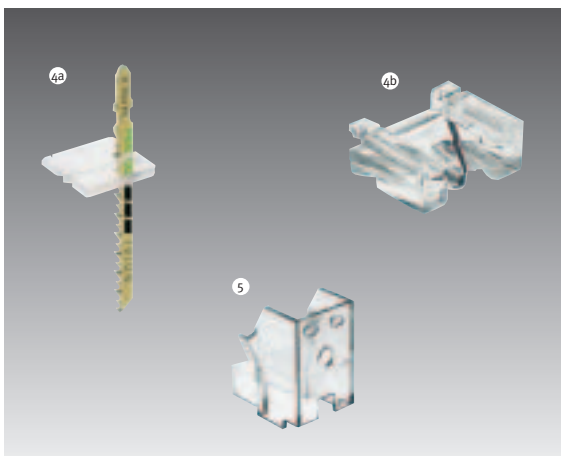

No.	Description and application	Type	Item No.	Price
4	<b>Splinter guard</b> for top quality cut edges, prevents splintering			
4a	Pack of 5 for PS 300/PSB 300 Pack of 20 for PS 300/PSB 300	SP-PS/PSB SP-PS/PSB 20	490 120 490 121	4.00 11.50
4b	Pack of 5 for PS 2 Pack of 20 for PS 2	PSP-PS PSP-PS 20	483 372 488 662	4.00 11.50
5	<b>Chip guard (replacement)</b> for a clear view of the workpiece, protects against flying chips, For PS 300/PSB 300 For PS 2	SF-PS300 SF-PS 2	453 491 448 596	2.00 2.00

# Blades for pendulum jigsaw PS 300 EQ/PSB 300 EQ/PS 2 E

The right saw blade for every need

## Saw blades

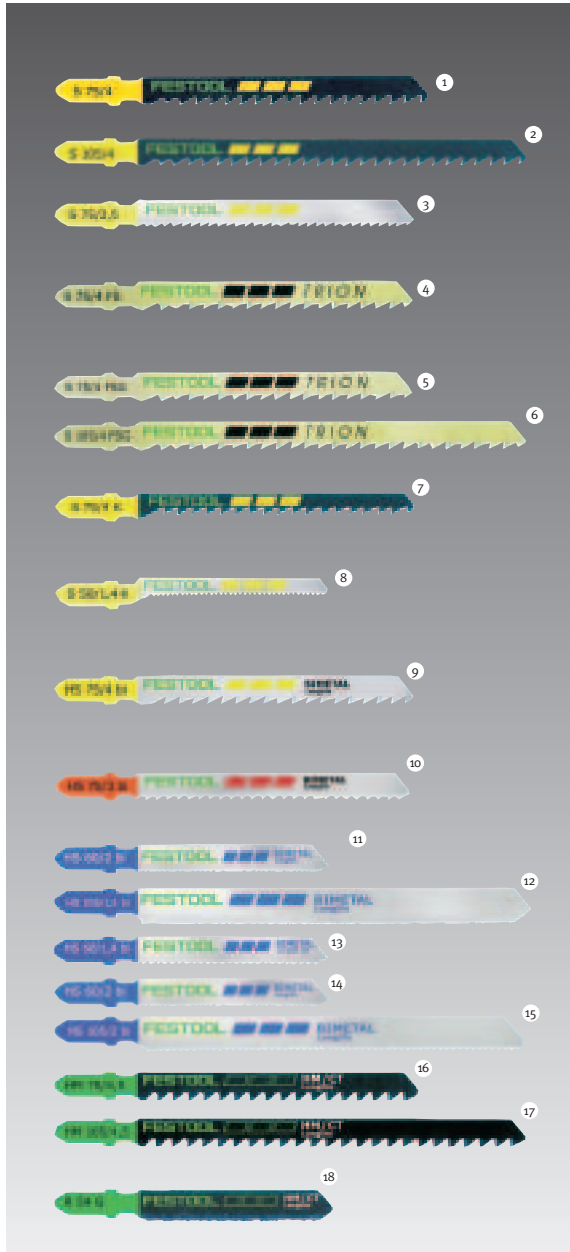

No.	Type	Length of blade	Tooth pitch mm	Tooth type	Max. material thickness	Qty. in pack	Item No.	Price
①	S 75/4	3" (75 mm)	4		< 2 1/8" (55 mm)	5	486 546	7.50
	<b>S 75/4</b>	3" (75 mm)	4		< 2 1/8" (55 mm)	<b>25</b>	486 962	33.50
②	S 105/4	4 1/8" (105 mm)	4		< 3 3/8" (85 mm)	5	486 547	12.50
③	S 75/2.5	3" (75 mm)	2.5		< 2 1/8" (55 mm)	5	486 548	8.50
	<b>S 75/2.5</b>	3" (75 mm)	2.5		< 2 1/8" (55 mm)	<b>25</b>	486 963	38.00
④	S 75/4 FS	3" (75 mm)	4		< 2 1/8" (55 mm)	5	486 549	11.00
	<b>S 75/4 FS</b>	3" (75 mm)	4		< 2 1/8" (55 mm)	<b>20</b>	490 256	40.00
⑤	S 75/4 FSG	3" (75 mm)	4		< 2 1/8" (55 mm)	5	486 551	13.50
⑥	S 105/4 FSG	4 1/8" (105 mm)	4		< 3 3/8" (85 mm)	5	486 552	18.00
	<b>S 105/4 FSG</b>	4 1/8" (105 mm)	4		< 3 3/8" (85 mm)	<b>20</b>	488 015	69.50
	S 145/4 FSG	5 3/4" (145 mm)	4		< 4 3/4" (120 mm)	5	490 179	23.00
⑦	S 75/4 K	3" (75 mm)	4		< 2 1/8" (55 mm)	5	486 563	7.50
	<b>S 75/4 K</b>	3" (75 mm)	4		< 2 1/8" (55 mm)	<b>25</b>	486 965	37.00
⑧	S 50/1.4 K	2" (50 mm)	1.4		< 1 3/10" (30 mm)	5	486 564	7.50
⑨	HS 75/4 bi	3" (75 mm)	4		< 2 1/8" (55 mm)	5	486 553	14.00
⑩	HS 75/3 bi	3" (75 mm)	3		< 2 3/8" (60 mm)	5	486 554	14.00
	HS 75/2.5 bi	3" (75 mm)	2.5	<b>BIMETALL</b> 	< 2 1/8" (55 mm)	5	490 178	14.00
⑪	HS 60/1.2 bi	2 3/8" (60 mm)	1.2		< 1 3/10" (30 mm)	5	486 556	12.50
	<b>HS 60/1.2 bi</b>	2 3/8" (60 mm)	1.2		< 1 3/10" (30 mm)	<b>25</b>	488 016	54.50
⑫	HS 105/1.2 bi	4 1/8" (105 mm)	1.2		< 3 3/8" (85 mm)	5	486 558	14.50
	HS 155/1.2 bi	6" (155 mm)	1.2		< 5 1/8" (130 mm)	5	490 180	15.00
⑬	HS 60/1.4 bi VA	2 3/8" (60 mm)	1.4		< 1/16" (1.5 mm)	5	490 181	12.50
⑭	HS 60/2 bi	2 3/8" (60 mm)	2		< 3/10" (30 mm)	5	486 557	12.50
⑮	HS 105/2 bi	4 1/8" (105 mm)	2		< 3 3/8" (85 mm)	5	486 559	14.50
⑯	HM 75/4.5	3" (75 mm)	4.5		< 2" (50 mm)	1	486 561	17.00
⑰	HM105/4.5	4 1/8" (105 mm)	4.5		< 3 1/8" (80 mm)	1	486 560	21.00
⑱	R 54 G	2 1/8" (54 mm)			< 3/16" (30 mm)	1	486 562	6.50

### Jigsaw blades in the handy Professional Pack:

Handy packs of 20 or 25 blades. A convenient way of ensuring that you always have enough blades on hand.

### Tooth, pitch, type and material



Cross-set teeth for fast cutting



Conically ground teeth for clean cuts



HCS tool steel: the standard quality for all wood materials



HS bimetal: long service and high cutting capacity



Coarse or fine saw blade: at least 3 teeth must engage workpiece at any time.



Carbide tipped (HM): resistant to high temperatures and hard wearing



Hard soldered carbide tipped splitter, fine



Corrugated blade, teeth milled

Features  
Materials

Softwood Hardwood	Chipboard	Coated chipboard Veneered plywood	Laminated boards	Fiber-reinforced plastics	Soft plastics	Acrylic Plexiglas®	Composite materials	MF-metals	Aluminum, steel sheets and section	Sandwich materials	Stainless steel	Iron and steel	Glass, tiles, ceramics

		①											
		②											
		③	③		③								
		④											
		⑤											
		⑥											
		⑦			⑦								
		⑧			⑧								
		⑨											
					⑩							⑩	
									⑪				
									⑫				
												⑬	
									⑭			⑭	
									⑮				
		⑯		⑯									
		⑰		⑰									
					⑱								⑱

Features of Festool jigsaws

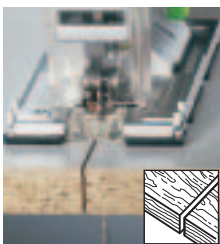

Clean cuts without splintering.



Cuts at precise angles.



Precise control in curves.



Long-life design for high cutting capacity and long service life.

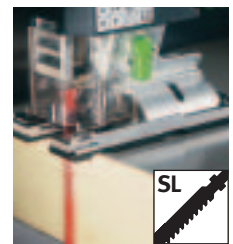

Super-long 6 1/8" (155 mm) blade for materials up to 5 1/8" thick.